

Spec-Kon®

Splices, Wire Joints, and Quick Splices

Features and Benefits

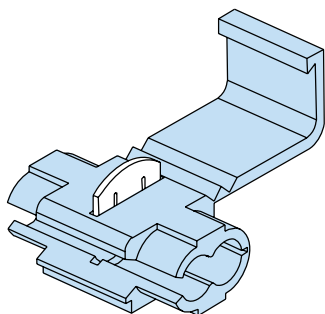

Splices / Wire Joints / Quick Splices

- Ideal for in-line splicing.
- Butt Splices available in Nylon, Vinyl, and non-insulated types.
- Vinyl Quick Splices are color-coded for wire ranges, and provide quick, easy in-line splicing and tapping.
- Nylon wire joint provides long-lasting, durable connection and can accommodate multiple leads. Rated 300 V at 105°C.
- Available in 22-10 AWG.

Design Features of Splices, Wire Joints and Quick Splices



Butt Splice

Ideal for in-line splicing applications

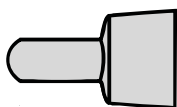

Wire Joints

Provides terminating point for a group of wires running in one direction

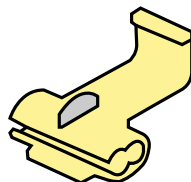

Quick Splices

Great for quick in-line splicing and tapping without stripping the wire insulation

Performance Requirements

Description	Wire Size (AWG)										
	#22	#20	#18	#16	#14	#12	#10	#8	#6	#4	#2
U.L. 486A (Terminals)											
Test Current for Max. 50°C Rise (Amps)	9	12	17	18	30	35	50	70	95	125	145
Min. Tensile Strength* (Lbs.)	8	13	20	30	50	70	80	90	100	140	160

* Pull-out force of the crimped terminal.

Applicable Spec-Kon® products meet or exceed the following test specifications:

- UL486A (Terminals)
- CSA
- UL486C (Splices)

UL listed products are shown with the applicable logos in the product section.

UL file #E9809 (Terminals).

CSA file #LR4503

Spec-Kon®

Splices, Wire Joints, and Quick Splices



- Internal Wire Stop
- Brazed Seams (Yellow - Tubular)
- Chamfered Funnel Entry

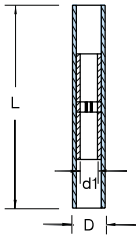

Nylon Insulated Butt Splice



Catalog Number	Wire Range	Dimension ^{inch} / _{mm}		
		L	D	d1
KN18-BS-M	22-16 A.W.G. 0.5-1.5 mm ²	1.075	.126	.067
		27.3	3.2	1.7
KN14-BS-M	16-14 A.W.G. 1.5-2.5 mm ²	1.075	.150	.091
		27.3	3.8	2.3
KN10-BS-D	12-10 A.W.G. 4-6 mm ²	1.110	.248	.134
		28.2	6.3	3.4

Box Quantity: (W)=250; (D)=500; (M)=1000

See pages in back of catalog for complete tool information.

Tool and Die Selection Chart on page M42.

UL File #9809

CSA File #LR4503

Maximum Electrical Rating: 105°C 600 Volts Max.

Connector Material: Copper



- Expanded Entry
- Brazed Seams (Yellow - Tubular)
- Internal Barrel Serrations

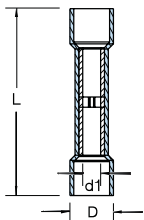

Vinyl Insulated Butt Splice



Catalog Number	Wire Range	Dimension ^{inch} / _{mm}		
		L	D	d1
KV18-BS-M	22-16 A.W.G. 0.5-1.5 mm ²	.986	.157	.067
		24.6	4.0	1.7
KV14-BS-M	16-14 A.W.G. 1.5-2.5 mm ²	.986	.177	.091
		24.6	4.5	2.3
KV10-BS-D	12-10 A.W.G. 4-6 mm ²	1.024	2.48	1.34
		26.0	6.3	3.4

Box Quantity: (W)=250; (D)=500; (M)=1000

UL File #E9809

CSA File #LR4503

See pages in back of catalog for complete tool information.

Tool and Die Selection Chart on page M42.

Maximum Electrical Rating: 75°C 600 Volts Max.

Terminal Material: Copper

Tool used with Nylon and Vinyl Insulated Butt Splice



ERG2500

M
Spec-Kon®

Spec-Kon®

Splices, Wire Joints, and Quick Splices



- Chamfered Barrel Entry
- Seamless Barrel Construction
- Wire Stop

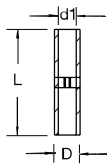

Non-Insulated Butt Splice

Catalog Number	Wire Range	Dimension ^{inch} / _{mm}			
		L	D	d1	T
K18-BS-M	22-16 A.W.G. 0.5-1.5 mm ²	.591 15.0	.130 3.3	.067 1.7	.031 0.8
K14-BS-M	16-14 A.W.G. 1.5-2.5 mm ²	.591 15.0	.154 3.9	.091 2.3	.031 0.8
K10-BS-M	12-10 A.W.G. 4-6 mm ²	.591 15.0	.213 5.4	.134 3.4	.039 1.0

Box Quantity: (M)=1000
UL File #E9809
CSA File #LR4503

Tool used with Non-Insulated Butt Splice

See pages in back of catalog for complete tool information.
Tool and Die Selection Chart on page M42.

Terminal Material: Copper Tubular



ERG2002



Nylon Insulated Wire Joint

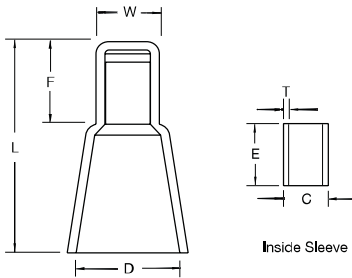

Inside Sleeve

Catalog Number	Wire Range	Dimension ^{inch} / _{mm}						
		W	F	L	D	E	T	C
KN18-WJ-M	22-16 A.W.G. 1.25 mm ²	.209 5.3	.315 8.0	.827 21.0	.386 9.8	276 7.0	.020 0.5	.091 2.3
KN14-WJ-M	16-14 A.W.G. 2 mm ²	.236 6.0	.354 9.0	.827 21.0	.394 10.0	276 7.0	.020 0.5	.122 3.1
KN10-WJ-D	12-10 A.W.G. 5.5 mm ²	.299 7.6	.394 10.0	1.004 25.5	.492 12.5	295 7.5	.028 0.7	.157 4.0

Box Quantity: (W)=250; (D)=500; (M)=1000
UL File #E66716
CSA File #LR4503

Tool used with Nylon Insulated Wire Joint

See pages in back of catalog for complete tool information.
Tool and Die Selection Chart on page M42.

Maximum Electrical Rating: 105°C 300 Volts Max.
Terminal Material: Copper Tube



ERG2500WJ

Vinyl Insulated Quick Splice

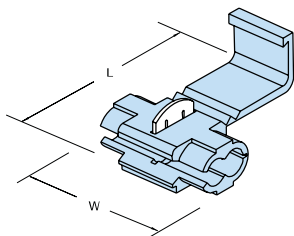

Catalog Number	Wire Range	Dimension ^{inch} / _{mm}		Color
		W	L	
KV14-OOQS-D	22-18 A.W.G. 0.5-1.0 mm ²	.787 20.0	1.063 27.0	red
KV18-OOQS-D	18-14 A.W.G. .75-2.5 mm ²	.787 20.0	1.063 27.0	blue
KV10-OOQS*	12-10 A.W.G. 4-6 mm ²	.807 20.5	1.358 34.5	yellow

Box Quantity: (W)=250; (D)=500; (M)=1000
* 200 piece quantity only.

See pages in back of catalog for complete tool information.
Tool and Die Selection Chart on page M42.

Maximum Electrical Rating: 105°C 600 Volts Max.
Terminal Material: Brass

Thomas & Betts



Crimp Terminals, Disconnects, and Splices

Thomas & Betts is pleased to introduce Spec-Kon® crimp terminals, disconnects, and splices. Ideal for OEM applications, the Spec-Kon® line can be used anywhere a high number of terminations are required every day, such as the wiring harness, panelboard, telecommunications, and automotive industries.

The Spec-Kon® terminal offering includes:

- A broad selection of bulk-packaged loose piece terminals in non-insulated and insulated varieties, including male and female disconnects, rings, forks, pins, blades, butt splices, wire joints and bullet connectors.
- Terminals on mylar tape for automated applications, including the new KT-2500 power tool for frequent, repeated crimps.
- The ERG-2500 ergonomic hand tool, which crimps all sizes of insulated barrel-style Spec-Kon® wire termination products.

Catalog Numbering System

Example: KV18-6R-M

K	V	18	6	R	M
Product	Terminal and Insulation	Wire Size Range	Feature Size	Terminal Type	Box Quantity
Thomas & Betts Spec-Kon® Terminals	(Blank) Bare Non-Insulated (V) Vinyl Funnel Entry (N) Nylon Funnel Entry (VF) Vinyl Fully Insulated (NF) Nylon Fully Insulated	(18) 22-16 AWG (14) 16-14 AWG (10) 12-10 AWG (8) 8 AWG (6) 6 AWG (4) 4 AWG (2) 2 AWG	Bolt Hole: Ring and Fork Terminals Tab Width: (250 Series) Disconnects Pin Length: Pin Terminals Blade Length: Blade Terminals Diameter: Bullets	(R) Ring (MS) Multiple Stud Ring (F) Fork (LF) Locking Fork (FF) Flanged Fork (PT) Pin Terminal (BL) Blade Terminal (MD) Male Disconnect (FD) Female Disconnect (FFD) Female Flag Disconnect (PD) Piggy Back Disconnect (FB) Female Bullet (MB) Male Bullet (BS) Butt Splice (QS) Quick Splice (WJ) Wire Joint (Closed End) (BFD) Barrel Flag Disconnect	(C) = 100 (CC) = 200 (W) = 250 (D) = 500 (M) = 1,000 (T) = Mylar Tape* * Please contact Customer Service for pricing and availability.